



24 Jimbour Street, WOOLLOOWIN QLD 4030

House: 4 beds 3 baths 2 park



SOLD by PETER CONNOR

SOLD

Positioned on a generous 410 sqm corner block in this leafy highly sought after pocket of Kalinga, this beautifully renovated Queenslander creates a welcoming first impression.

Once inside you are greeted by traditional features highlighted with contemporary tones and finishes blended seamlessly with a modern layout for easy everyday living to provide a comfortable, low-maintenance haven. The open plan living, dining and kitchen open out via beautiful timber bi-fold doors to the expansive covered outdoor deck, making the home perfect for entertaining all year round.

Set over two levels, the entry level hosts three generous bedrooms, main with ensuite and walk in robe.

The lower level provides an additional living area, bedroom, bathroom and laundry which could easily provide dual living opportunities. With access to the home from both levels, it is perfect for families of all sizes seeking space and practicality. On the ground level the 2 car garage includes ample workshop space for the home handyman.

Located in the highly desirable Eagle Junction State School catchment and close to Kalinga parklands, shops, cafes and public transport, 24 Jimbour Street represents a prime opportunity to reside in one of Brisbane's best inner city suburbs, offering an address of convenience and style ready for your immediate enjoyment.

- Large kitchen with stone bench-tops, European appliances and ample storage space/cabinetry
- Generous living and dining area flowing out to expansive covered deck
- 4 spacious bedrooms, main suite with ensuite and WIR
- Second living and bedroom area on lower level with dual living potential
- Minutes walking distance to Eagle Junction dining precinct and station



Peter Connor
Lead Agent

E:

peterconnor@placerealestate.com.au

M: 0403 740 251

Features

- Air Conditioning
- Built-In Wardrobes
- Close to Schools
- Close to Shops
- Close to Transport
- Garden



24 Jimbour Street, WOOLLOOWIN QLD 4030

House: 4 beds 3 baths 2 park

- 410 sqm of prime inner city real estate within Eagle Junction State School catchment

Close to Kalinga parklands, schools, shops and within easy access to many public transport options and major arterial roads, Airport link tunnel with easy access to both Sunshine and Pacific Motorways.

**This property is being sold by auction or without a price and therefore a price guide can not be provided. The website may have filtered the property into a price bracket for website functionality purposes



24 Jimbour Street, WOOLLOOWIN QLD 4030

House: 4 beds 3 baths 2 park

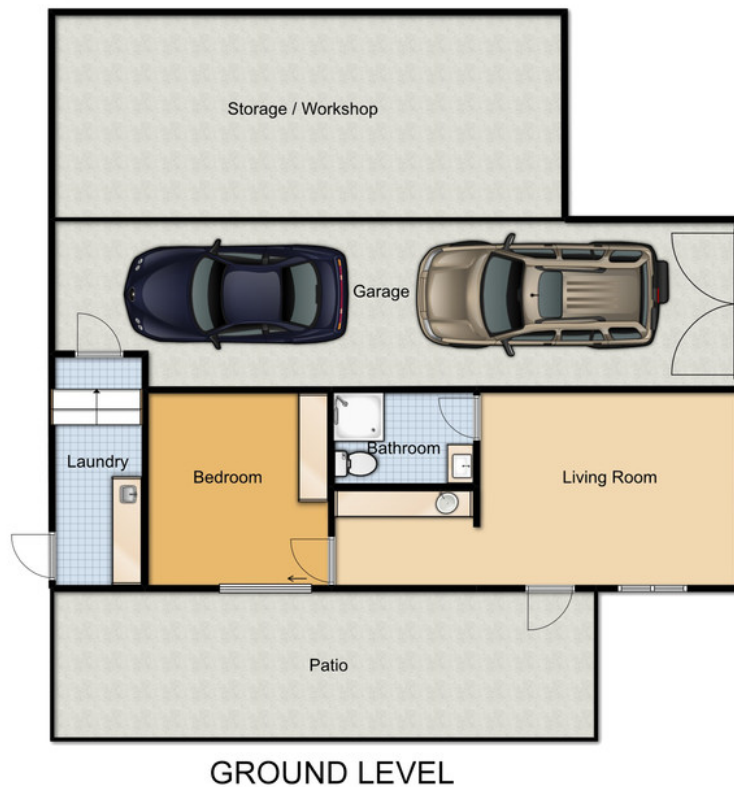

Whilst every attempt has been made to ensure accuracy, Floorplans are representative & should be used as a guide only.





24 Jimbour Street, WOOLLOOWIN QLD 4030

House: 4 beds 3 baths 2 park

